

A photograph of a large, modern school building with a light-colored facade and a prominent yellow section. The building has multiple stories and large windows. In the foreground, there is a paved area with some greenery and a few people walking. The sky is blue with scattered white clouds. The text is overlaid on the image in a green, italicized font.

Woodland Public Schools

Facilities and Safety
January 2017 report

FACILITIES REPORT

ESD Online Employee Accident/ Incident Reporting

Woodland Schools has offered to beta test the new online Employee Accident Report system created by ESD 112. The new form is completed online and accessed through the District Safety tab on the website. This link also includes access to the accident investigation form required to be filled out for all employee accidents.

Senior Tile Stand WHS

You may have noticed a new concrete structure at the entrance to the woodland high school. The senior tile stand was installed last week to accommodate 10 years of inspiring messages from our graduating youth. The stand is approximately 3 feet tall, 2 feet deep, 10 feet long and has casted slots for the tiles. The stand will be loaded with the stones, and then removed each year for engraving.

Card Key System

Security system upgrades for WIS, WPS and WMS are moving forward at a good pace. Door controller panels were installed at the schools last week, and we have received the system software delivered to the IT department for installation on the Districts network. Over the next two weeks, the system badge printers and door hardware will be installed. Additionally, the system controllers will be connected to the network, and power will be connected.

FACILITIES REPORT continued

Portable Install Woodland Intermediate School – Mechanical, electrical, foundation and site layout drawings were completed this last week. We are expecting to file building permits by the first week in March. A site walk-through and meeting was completed with the building manufacturer to shore up the logistics of moving the buildings into place. Additionally, a site walk through was completed with the Woodland Building and Planning Department, to ensure we will have no issues during the permitting process. The buildings are planned to be placed on the school grounds during the first week of summer.

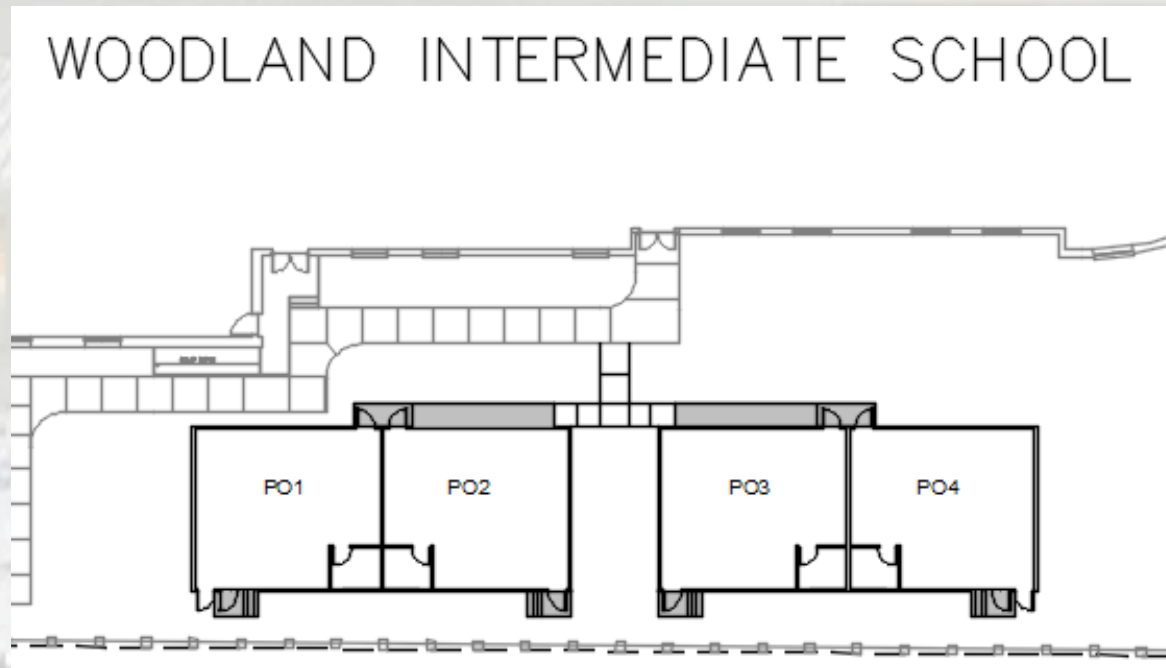

Drawing showing the portables' location on the south side of the school

FACILITY CHARTS – POWER COST AND WORK ORDER STATUS

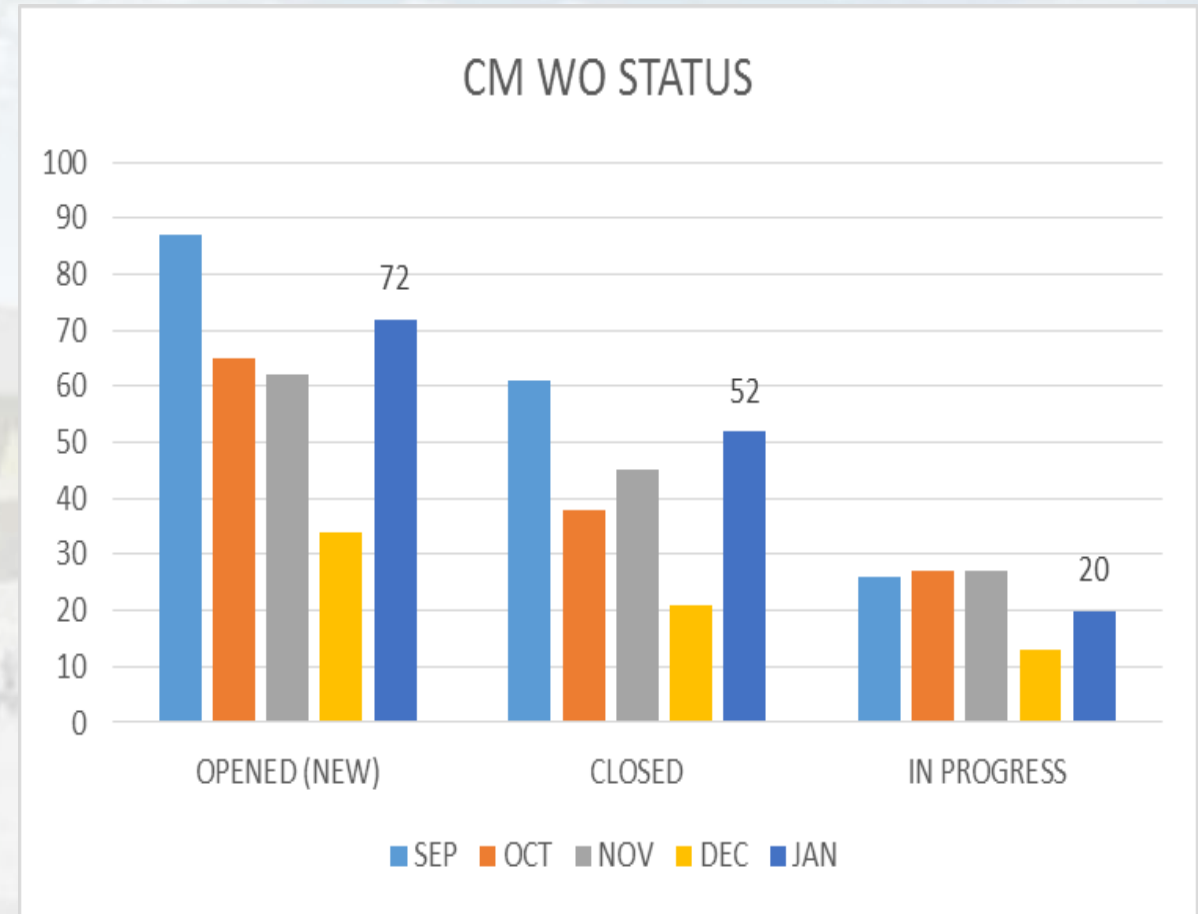
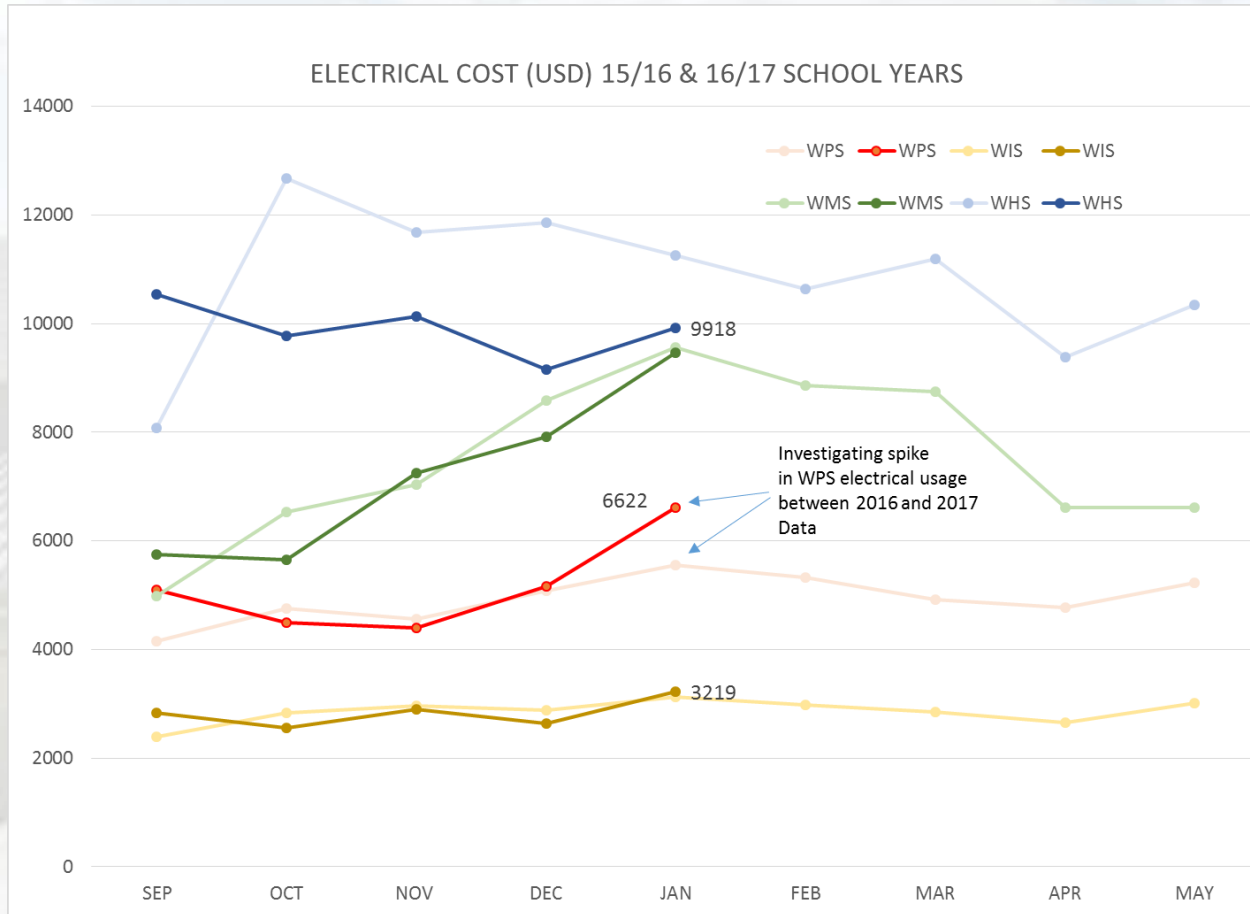

FACILITY CHARTS – WATER USAGE- WHS, WIS, WMS, WPS

Water billed every two months.
Next update will be in March
report for Jan and Feb Consumption

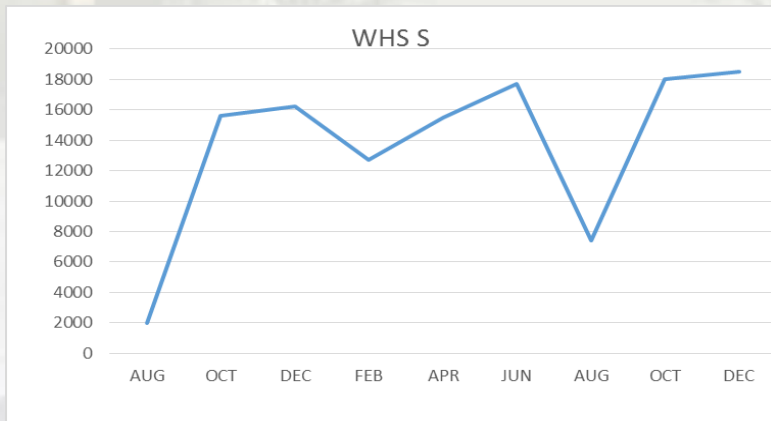
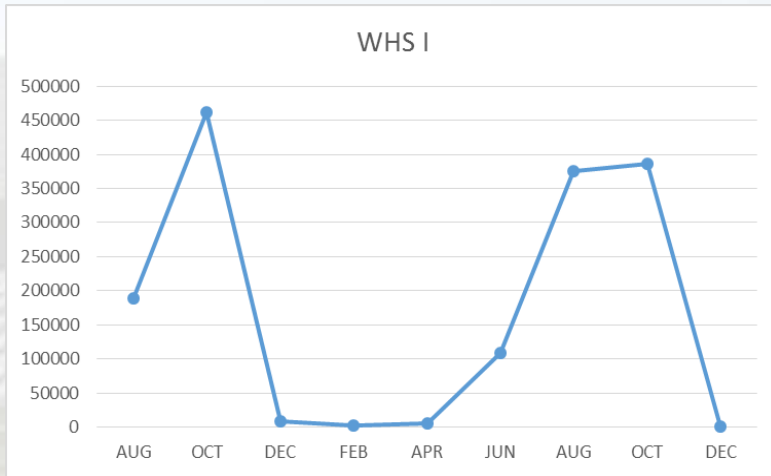
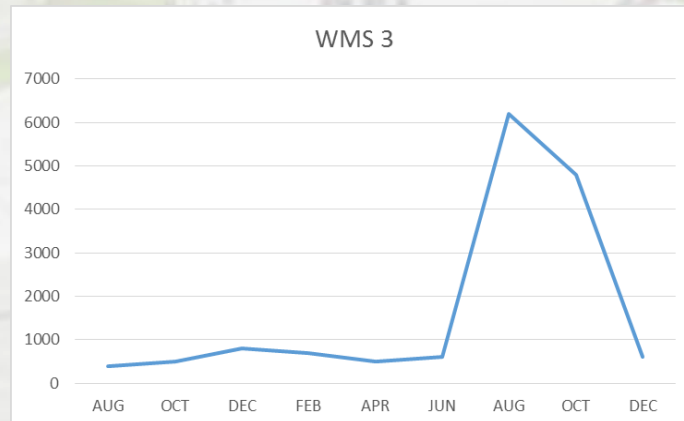
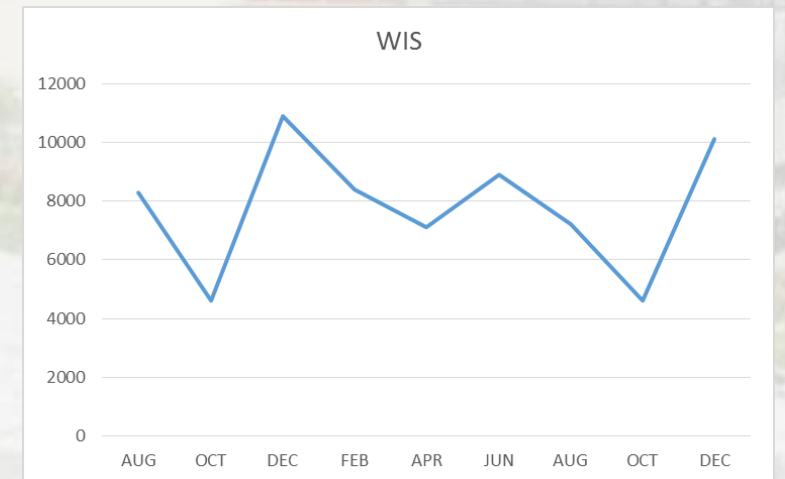
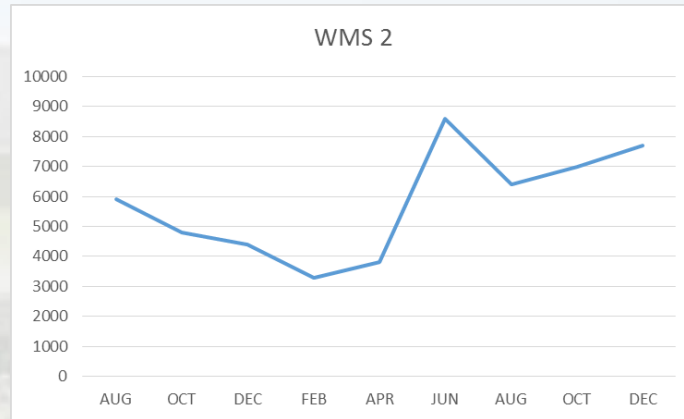
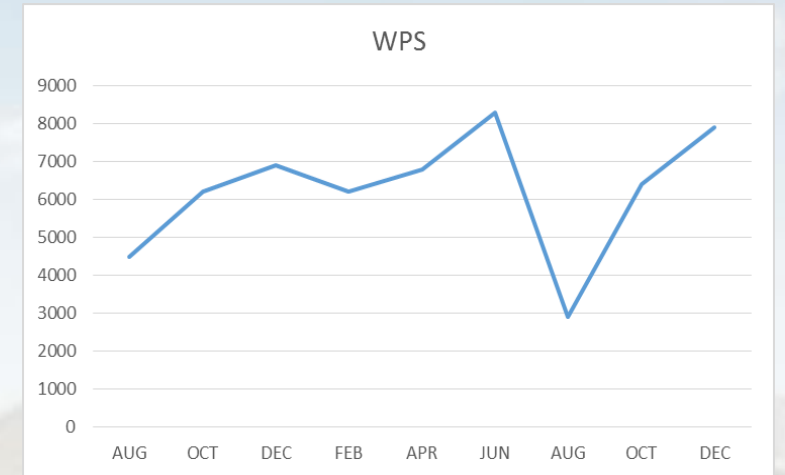
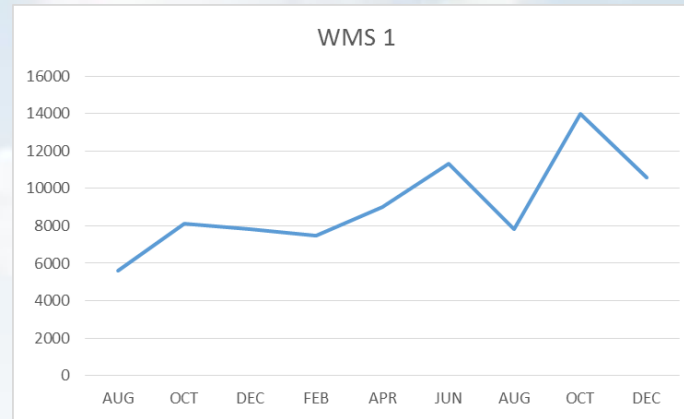

SAFETY

Accidents for the Month

There were a total of 17 injuries in the month of December-2 students and 15 staff members. A large spike in staff related incidents and accidents were noted at WPS.

Staff Accidents/Incidents (15)

- WPS – Students kicked/punched IA's multiple times (14 events with varying injuries).
- WIS – Employee slipped on stair while cleaning

Student Accidents/Injuries (2)

- WHS – Student hurt shoulder while wrestling.
- WHS – Student ran into wall during practice game and injured head (concussion assessment completed)



SAFETY CHARTS

